



2000-series Mill Z-axis Leadscrew Length

About the 2000 Mill Z-axis Leadscrew

The overall length of our 2000 Z-axis leadscrew is standardized at 8.263".

If you bought a 2000-series mill before 9/1/2015, and you have recently purchased a replacement Z-axis leadscrew, there may be a chance that the screw will not clear the Arm Mount (P/N 56440). In this instance, the column bed will sit too low, and the end of the leadscrew will interfere with the arm mount. If this is the case, then check the orientation of the Movable Clamping Disk (P/N 35170).

Proper Orientation of the Movable Clamping Disk

There is a right way or a wrong way to mount the Movable Clamping Disk to the Arm Mount (See Figure 1). The Movable Clamping Disk can be mounted to the Arm Mount (See #16 in the exploded view below) in two directions. The small, 4-hole pattern on the disk is off center to one side. If you mount the bed to the arm with the large space

facing up, there will be interference with the leadscrew. Remove the column bed, turn the Movable Clamping Disk 180 degrees, so the short space is on top and remount your bed. Now the screw should clear the top of the Arm Mount. When installed correctly, there should be clearance between the end of the leadscrew and the top of the arm mount.

Thank you,
Sherline Products Inc.

RIGHT

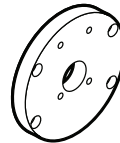

WRONG

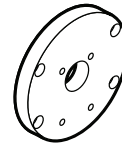

FIGURE 1—Shows the proper orientation of the movable clamping disk (See #2 in the exploded view below).

2000 Mill Column Exploded View

